

5 Paul Elkow Building Co., LLC - The Meadows of Hidden Lake

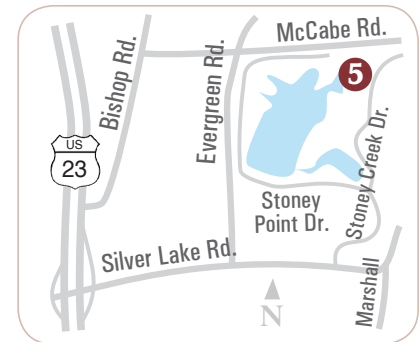

Above: Conceptual rendering.
Example pictured differs from current model.
(Photo not yet available at time of printing)



Exit at Silver Lake Road off US-23.
Head east 1.3 miles and turn
left on Stoney Creek Drive. Take
Stoney Creek Drive to back of the
community/end of Stoney Creek.

8350 STONEY CREEK DRIVE, SOUTH LYON

NEW MODEL NOW OPEN

Enjoy a carefree detached villa-style condominium with lake privileges on all sports Hidden Lake. Community features include picturesque gardens, waterfalls, miles of walking trails, an amphitheater and a marina.

Floor plans available to fit any lifestyle ranging from 1,743 sq. ft. – 2,711 sq. ft. Generous use of space, open floor plans, soaring ceilings, walkout & daylight basements. You'll love the bonus of a 3 car garage, deck and landscaping, all included.

For information on "Model Opening" prices and floor plans, please call or text Diane Braykovich at 248-787-4545 or email dianebraykovich@remax.net.



248-787-4545
PaulElkowBuilding.com

UPPER LEVEL

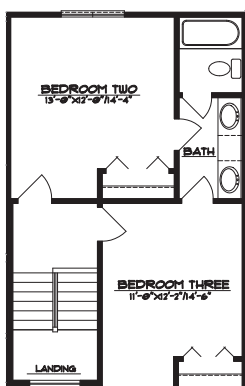

MAIN LEVEL

